

Ejector Blades

M-2 STEEL

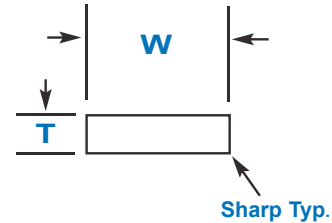
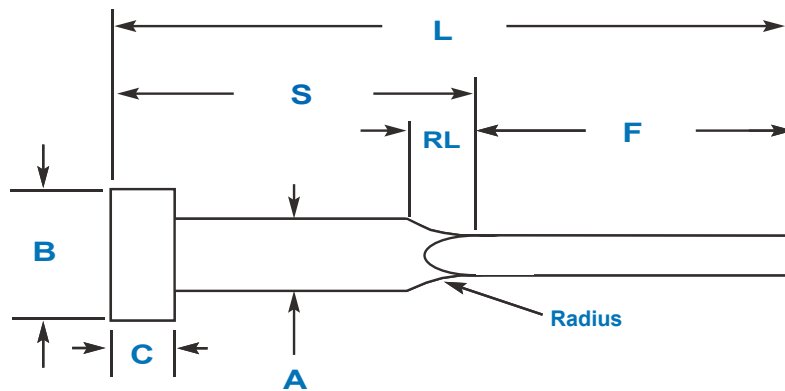

Advantages of M-2 Steel

- High Chromium M-2 Steel 58-60 Rc resists corrosion, galling & pitting
- One piece design with High Column strength & accuracy
- Parallel Ground - smoother running and less cavity wear
- Manufactured In-House for cost effective rapid delivery
- Durable, Rigid, Tempered for Extra Strength
- Smooth Grind Finish
- Customs to any size and tolerance

Standard Tolerances

	Inch	Euro Metric
A	+0.000 -0.001	-0.005 -0.012
B	+0.000 -0.010	+0.000 -0.200
C	+0.000 -0.002	+0.000 -0.050
F	+0.060 -0.000	+1.00 -0.000
L	+0.060 -0.000	+2.00 -0.000
RL	+0.030 -0.030	+1.00 -1.00
S	+0.030 -0.030	+1.00 -1.00
T	+0.0000 -0.0003	+0.000 -0.015
W	+0.0000 -0.0003	+0.000 -0.015
Radius	2"	50.8

US Inch Blades

- Diameters from .062" up to .500"
- Shanks available in 7 lengths
- Overall lengths up to 10"
- Blade lengths up to 6"
- 350 Standard Sizes

Euro Metric

- Diameters from 4MM up to 16MM
- Overall lengths up to 400MM
- Blade lengths up to 200MM
- 164 Standard Sizes